

## INSTRUCTION MANUAL MODULAR LED LIGHT



Thank you for choosing **WELL**. Please read carefully the following instructions and keep them within reach.

**Reorder No:** LEDWLN-CRYSTAL-1-WL, LEDWLN-CRYSTAL-6-WL

**Functional description:**

The touch modular LED system splices hexagonal modules together by magnetic attraction. Users can DIY splice different patterns according to different numbers of modules, which can give consideration to wall lighting and decoration.

**Product classification:**

Conventional touch module, powered by AC/DC 12 V.

**Usage:**

The sensor will detect the user's operation and execute the corresponding light on or off mode only by lightly touching the module to be lit.

**Installation steps:**



Select the installation location you want and ensure that the socket is at a sufficient distance from the wire.

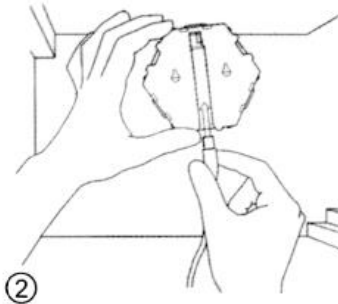

Connect the power supply to the rear of a single hexagonal lamp panel.

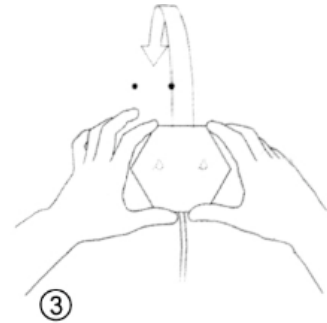

Drill hole on the back of the wall and fix the first hexagon on the wall with nails.

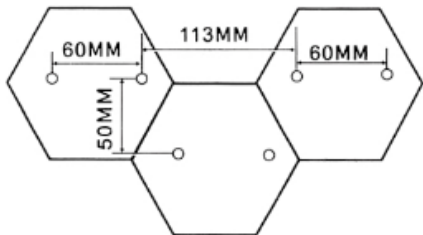

Nail installation distance schematic template

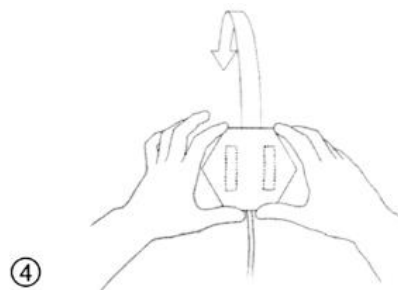

Use glue and other means to fix on the wall. (Special reminder: when splicing large light screens, it is recommended to reinforce the modules in the middle with nails, which will give strong support to the surrounding modules).

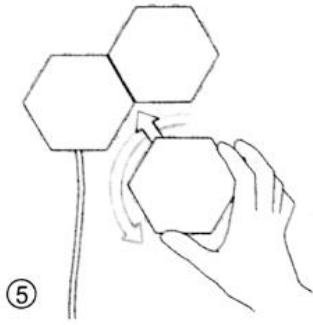

Splicing each hexagonal body together, and mutually adsorbing the modules through magnetic force.

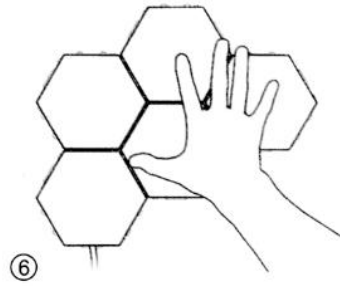

After the module splicing is completed, gently touch with your hand to ensure that each hexagonal lamp panel can emit light.

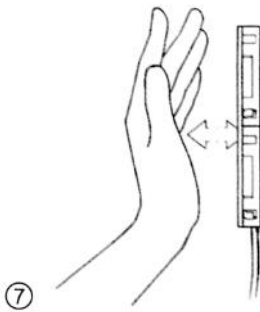

Just touch the module you want to light with your hand, and the built-in sensor will detect your operation and execute the corresponding light switch operation. Do not operate with explosive force.

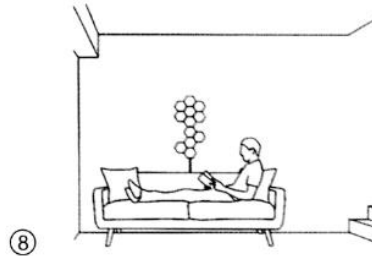

Under light, let's share your design.

**Note:**

This product is not suitable for children or the weak.

Do not expose this product to sunlight or damp areas.

Please use the factory configured power adapter and do not use other power adapters.

It is strictly prohibited to put this product into a fire source or close to a high temperature source to avoid fire and explosion hazards.

If the product has quality problems, please contact the merchant for repair or replacement. Unauthorized disassembly or rough use is strictly prohibited.

Do not pull the power cord plug hard. Press and hold the module connected to the power supply with one hand, hold the plug with the other hand and gently pull it out.

**Product maintenance:**

Before cleaning the product, please disconnect the power supply of the system, wipe the surface of the test module with dry cloth, do not clean with liquid or corrosive materials, and do not scratch the shell with hard objects.

**Specifications****LEDWLN-CRYSTAL-1-WL:**

Product material: ABS+PC

Number of LED: 36x 0.2W

Power supply: 12V, 2A

Color temperature: 4000K

Luminous flux: 150lm

Average Lifetime:  $\geq 10000$ h

Casing color: white

Module size: 100x115x18mm

Package content: 1x LED hexagonal light, sticker, user manual

Power adapter is not included

**LEDWLN-CRYSTAL-6-WL:**

Product material: ABS+PC

Number of LED: 36x 0.2W

Power supply: 12V, 2A

Color temperature: 4000K

Luminous flux: 900lm

Average Lifetime:  $\geq 10000$ h

Casing color: white

Module size: 100x115x18mm

Package content: 6x LED hexagonal light, power adapter, 6x stickers, user manual



Waste electrical and electronic equipment are a special waste category, collection, storage, transport, treatment and recycling are important because they can avoid environmental pollution and are harmful to health. Submitting waste electrical and electronic equipment to special collection centers makes the waste to be recycled properly and protecting the environment. Do not forget! Each electric appliance that arrives at the landfill, the field, pollutes the environment!

**Importer & distributor:**

SC VITACOM ELECTRONICS SRL

CIF: RO 214527

Tel. 0264-438401\*

[office@vitacom.ro](mailto:office@vitacom.ro), [www.vitacom.ro](http://www.vitacom.ro)